

# ECOSYS MA2100cwfxf:

## A classic, redefined

With the new ECOSYS MA2100cwfxf, we have transformed a hugely popular legacy device, making it the perfect fit for the new age of work. This compact and highly reliable A4 printer combines the best of Kyocera's ECOSYS technology with modern innovation to meet the needs of the most demanding workspaces, be they in the office or across remote locations.

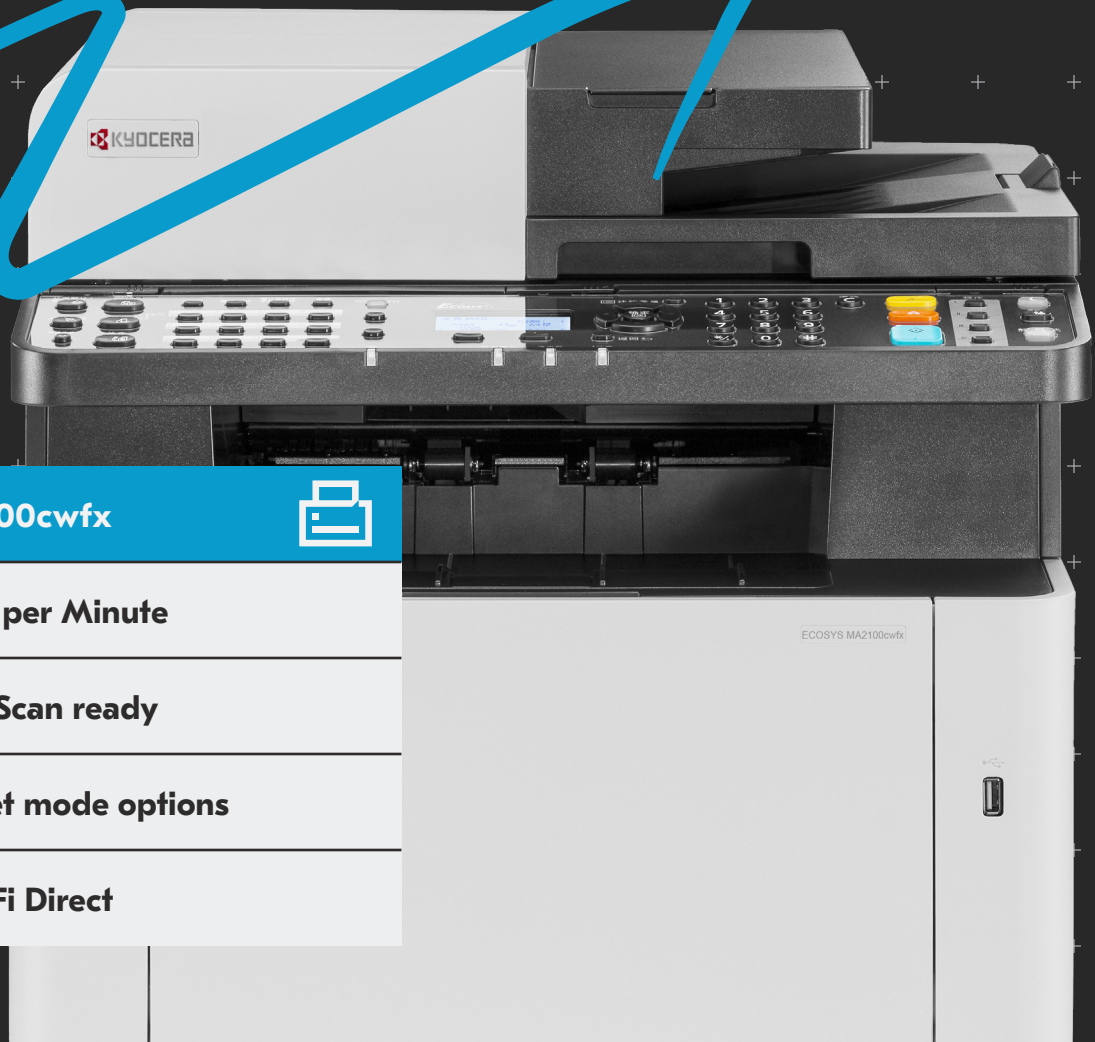

**ECOSYS MA2100cwfxf**



**Up to 22 Pages per Minute**

**Mobile Print & Scan ready**

**EcoPrint & Quiet mode options**

**Wireless & Wi-Fi Direct**

## ECOSYS MA2100cwfX

### BASIC SPECIFICATIONS

**Configuration:** Color Multifunctional Printer – Print / Scan / Copy / Fax  
**Pages Per Minute:** Black – Letter: 22 ppm, Legal: 18 ppm, A4: 21 ppm  
**Color – Letter:** 22 ppm, Legal: 18 ppm, A4: 21 ppm  
**Warm Up Time:** 32 Seconds or Less (Power On), 12 Seconds or Less from Sleep  
**First Page Out:**  
Copy: 10 Seconds or Less Black, 12 Seconds or Less Color  
Print: 11 Seconds or Less Black, 12.5 Seconds or Less Color<sup>1</sup>  
**Display:** 5 Line LCD Screen with Hard Key Control Panel  
**Resolution:** 600 x 600 dpi, 9600 dpi equivalent x 600 dpi, 1200 x 1200 dpi<sup>1</sup>  
**Memory:** Standard 512MB, Upgradable to 1.5GB  
**Duplex:** Standard Stackless Duplex Supports Statement to Legal (5.5" x 8.5" – 8.5" x 14"), 16 lb – 32 lb Bond (60 – 120gsm)  
**Dimensions:** 16.4" W x 16.9" D x 19.5" H  
**Weight:** 57.3 lbs  
**Maximum Monthly Duty Cycle:** 65,000 Pages per Month

### POWER CONSUMPTION

**Electrical Requirements:** 120V, 60Hz, 8.6A; 220 – 240V, 50/60Hz, 4.5A  
**Typical Electricity Consumption (TEC):** 120V: 811.7 Wh/week; 220 – 240V: 730 Wh/week  
**Maximum (including options):** 120V: 1,007 W; 220 – 240V: 1,066 W  
**Copying / Printing:** 120V: 345 W; 220 – 240V: 345 W  
**Ready Mode:** 120V: 41 W; 220 – 240V: 41 W  
**Sleep Mode:** 120V: 1 W; 220 – 240V: 1 W  
**Power Off:** 120V: 0.2 W; 220 – 240V: 0.2 W

### PAPER SUPPLY

**Standard Paper Sources:** Single 250 Sheet Drawer, 50 Sheet Multi-purpose Tray  
**Standard / Maximum Paper Sources:**  
2 / 3 including Multi- purpose Tray  
**Standard / Maximum Paper Capacity:**  
300 Sheets / 550 Sheets  
**Paper Size:** Standard / Optional / Drawers: 5.5" x 8.5" – 8.5" x 14" (Statement to Legal)  
**Paper Weight:** Standard / Optional Drawers: 16 lb Bond – 90 lb Index (60 – 163gsm); MPT: 16 lb Bond – 120 lb Index (60 – 220gsm)  
**Input Materials:** Standard / Optional Drawer: Plain Paper, Bond Paper, Recycled Paper; MPT: Labels, OHP, Envelopes, Coated Paper  
**Standard Output Tray Capacity:** 150 Sheets

### PRINT SPECIFICATIONS

**Standard Controller:** Cortex-A9 / 800MHz  
**PDLs / Emulations:** PRESCRIBE, PCL6 (PCL5c/PCL-XL), KPDL3 supporting AES, PDF Direct Print, XPS/OpenXPS Direct Print  
**Windows OS Compatibility:** Windows 8.1/10/11 / Server 2012 / Server 2012 R2 / Server 2016 / Server 2019  
**Mac OS Compatibility:** Apple Macintosh OS X 10.9 or higher  
**Interfaces:** Standard: 10 BASE-T/100 BASE-TX / 1000 BASE-T, High-speed USB 2.0, 1 USB Host, Wireless LAN IEEE 802.11b/g/n, Wi-Fi Direct  
**Linux OS**  
**Mobile Printing:** Apple AirPrint®, KYOCERA Mobile Print, Mopria®  
**Network Print and Supported Protocols:** TCP/IP, IPv4, IPv6, NetBEUI, FTP, LPR, IPP, WSD Print/Scan, DHCP, DNS, Apple Bonjour, LDAP, SNMP v2/3, HTTP, SMTP, POP3, PDF Direct Print (using KYOCERA NET Direct Print utilities)  
**Drivers:** KX Driver, KX Driver for XPS, PCL Mini Driver, KPDL Mini Driver, Network Fax Driver, TWAIN Driver, WIA Driver, MAC Driver, Linux Driver  
**Utilities:** KYOCERA Net Direct Print, File Management Utility, KYOCERA Mobile Print, KYOCERA Print Center, KYOCERA Device Manager, KYOCERA Net Viewer, ID Register, Wi-Fi Setup Tool, Remote Work Assistant, KYOCERA Quick Scan, Status Monitor  
**Additional Print Features:** EcoPrint; Quick Copy<sup>2</sup> and Job Storage<sup>3</sup>; Private Print<sup>3</sup> and Proof and Hold<sup>3</sup>

### SCAN SPECIFICATIONS

**Scan Type:** Color and Black & White Scanner  
**Scan Resolution:** 300 x 600 dpi, 300 dpi, 600 dpi  
**Scanning Functions:** Scan to Folder (SMB), Scan to Email, Scan to FTP, Scan to FTP over SSL, WSD Scan, Scan to USB, TWAIN/WIA Scan  
**File Formats:** TIFF, PDF, High-compression PDF, XPS, OpenXPS, JPEG, Encrypted PDF, PDA/A-1  
**Scan Speeds through ADF:**  
Mono: Simplex @300 dpi – 30 ipm, @600 dpi – 18 ipm Color:  
Simplex @300 dpi – 23 ipm, @600dpi – 6 ipm  
**Original Size:** Through Document Processor: Statement to Legal (5.5" x 8.5" – 8.5" x 14"); Glass: Up to 8.5" x 11"

### COPY SPECIFICATIONS

**Image Mode:** Text, Photo, Text & Photo, Graphic/Map, Printed Document Mode  
**Continuous Copy:** 1-999 / Auto Reset to 1  
**Job Management:** Job Accounting, 20 Department Codes, Shortcut Keys  
**Magnification / Zoom:** Full Size, 7 Reduction, 5 Enlargement, Preset Ratios, 25 – 400% (in 1% increments)  
**Additional Copy Features:** Auto Zoom

### SECURITY SPECIFICATIONS

**Standard:** Local Authentication, Network Authentication, IPsec, SNMPv3, LDAP over SSL, IEEE 802.1x, IPP over SSL/TLS, HTTPS, FTP over SSL/TLS, SMTP over SSL/TLS, POP3 over SSL/TLS, Enhanced WSD over SSL/TLS, TLS 1.2, SMBv3, SHA-2 384  
**Optional:** Card Authentication Kit (B)

### DOCUMENT PROCESSOR

**Type / Capacity:** Standard Automatic Document Feeder (ADF) / 50 Sheets  
**Acceptable Originals:** Statement to Legal (5.5" x 8.5" – 8.5" x 14")  
**Acceptable Weights:** Simplex: 13 – 42 lb Bond (50 – 160gsm), Duplex: 13 – 32 lb Bond (50 – 120gsm)

### FAX SPECIFICATIONS

**Compatibility / Data Compression:** ITU-T G3 Fax / MMR, MR, MH, JBIG  
**Transmission Speed / Modem Speed:** 3 Seconds or Less / 33.6Kbps  
**Fax Memory:** 3.5MB  
**Fax Functions:** Simplex Transmission / Duplex Reception, One Touch Dial (22 numbers, a maximum of 22 destinations can be registered with physical 11 numbers key & shift key), Quick Dial (100 numbers), Sequential Broadcast (100 numbers), Density Adjustment, Original Image Quality, Continuous Scan, Timer Send, Fax Reports

### PAPER HANDLING OPTION

**PF-5110:** 250 Sheet Paper Feed Drawer  
**Paper Size / Weight:** 5.5" x 8.5" – 8.5" x 14" (Statement to Legal) / 16 lb Bond – 90 lb Index (60 – 163gsm)  
**Dimensions:** 8 lbs.  
**Weight:** 16.5" x 19" x 6"

### ADDITIONAL OPTIONS

**Memory:** 512MB DIMM Memory, 1GB DIMM Memory  
**SD Card:** 16 / 32GB  
**Security:** Card Authentication Kit (B)  
**Print Management:** ThinPrint (UG-33)

### Note:

- <sup>1</sup> At reduced speed
- <sup>2</sup> Requires optional SD Card
- <sup>3</sup> Requires optional Memory or SD Card

Specifications and design are subject to change without notice. For the latest on connectivity visit [kyoceradocumentsolutions.us](http://kyoceradocumentsolutions.us). ECOSYS, PRESCRIBE, Kyocera Net Manager, Kyocera Net Viewer, Kyocera Device Manager, PDF Direct Print, Command Center RX, and KX Driver are trademarks of The Kyocera Companies. Mac OS and AirPrint are trademarks of Apple, Inc. Mopria is a trademark of Mopria Alliance, Inc. Windows is a trademark of Microsoft, Inc. All other trademarks are the property of their respective owners.



Kyocera Document Solutions Partner

KYOCERA Document Solutions America  
225 Sand Road, PO Box 40008  
Fairfield, New Jersey 07004-0008, USA  
Tel: 973-808-8444



[kyoceradocumentsolutions.us](http://kyoceradocumentsolutions.us)

Kyocera Document Solutions does not warrant that any specifications mentioned will be error-free. Specifications are subject to change without notice. Information is correct at time of going to press. All other brand and product names may be registered trademarks or trademarks of their respective holders and are hereby acknowledged.  
©2022 KYOCERA Document Solutions America, Inc.